

**LOCATION OF RESEARCH PLOTS
ESTABLISHED BY THE DEPARTMENT
OF FISHERIES AND FORESTRY,
EASTERN REGION, MANITOBA**

by
V. S. Kolabinski

**FOREST RESEARCH LABORATORY
WINNIPEG, MANITOBA
INTERNAL REPORT MS-99**

**FORESTRY BRANCH
DEPARTMENT OF FISHERIES AND FORESTRY
JULY, 1969**

ACKNOWLEDGEMENT

The Department of Fisheries and Forestry wishes to acknowledge the continued interest, co-operation, and assistance of the Manitoba Department of Mines and Natural Resources in the establishment and protection of the research plots listed herein. Areas for research were generally selected in co-operation with provincial forestry personnel who often supervised or carried out logging operations as well as site preparations required for individual studies.

LOCATION OF RESEARCH PLOTS ESTABLISHED

BY THE

DEPARTMENT OF FISHERIES AND FORESTRY,

EASTERN REGION, MANITOBA

by

V.S. Kolabinski¹

This report shows the location of all permanent and semipermanent research plots established by the Canada Department of Fisheries and Forestry in the Eastern Region of Manitoba. Location maps have been prepared for each section in which a plot is located using a scale of one inch to 20 chains. Roads are indicated by parallel solid lines and trails by dashed lines. Provincial road numbers are indicated by a prefix MPR and trunk highways by the prefix PTH.

Each mapped section occupies a single page so that as projects are closed or new ones initiated, pages can be added to or removed from the report. The mapped sections are divided into the areas East of the Prime Meridian and those West of the Prime Meridian. The top right-hand corner of each map shows its location in order of township, range and section; these designations also constitute the page-numbering system of the report. Within each township maps are in order of range, then within each range in order of section.

The final part of the report shows a listing of each research project. The file number and title of the project, the name of the investigator, his section head, and the location of each plot in order of township, range and section is given.

¹Forest Research Technician, Liaison and Services Section (Silviculture), Forestry Branch, Department of Fisheries and Forestry, Winnipeg, Manitoba.

If logging activity or other disturbances is contemplated in the vicinity of a plot, it would be appreciated if the investigator or appropriate section head was notified. In most instances a two chain buffer strip around the plot would be desirable. The investigator will be responsible for the demarcation of the buffer strip.

E.P.M.

12 - 15 - Sec.17, E.P.M.

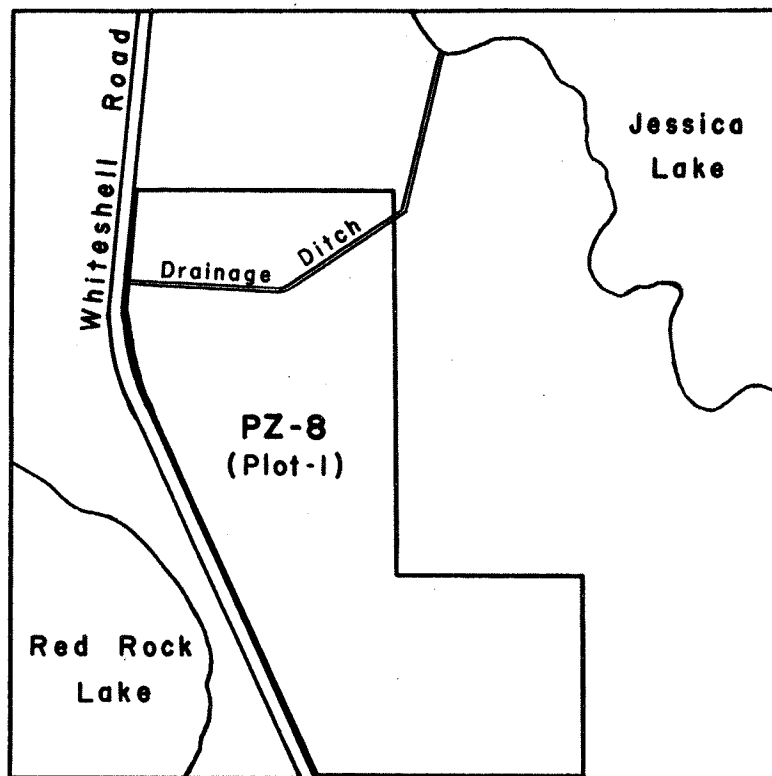

Scale: 1 inch = 20 chains

13-13- Sec. 36, E.P.M.

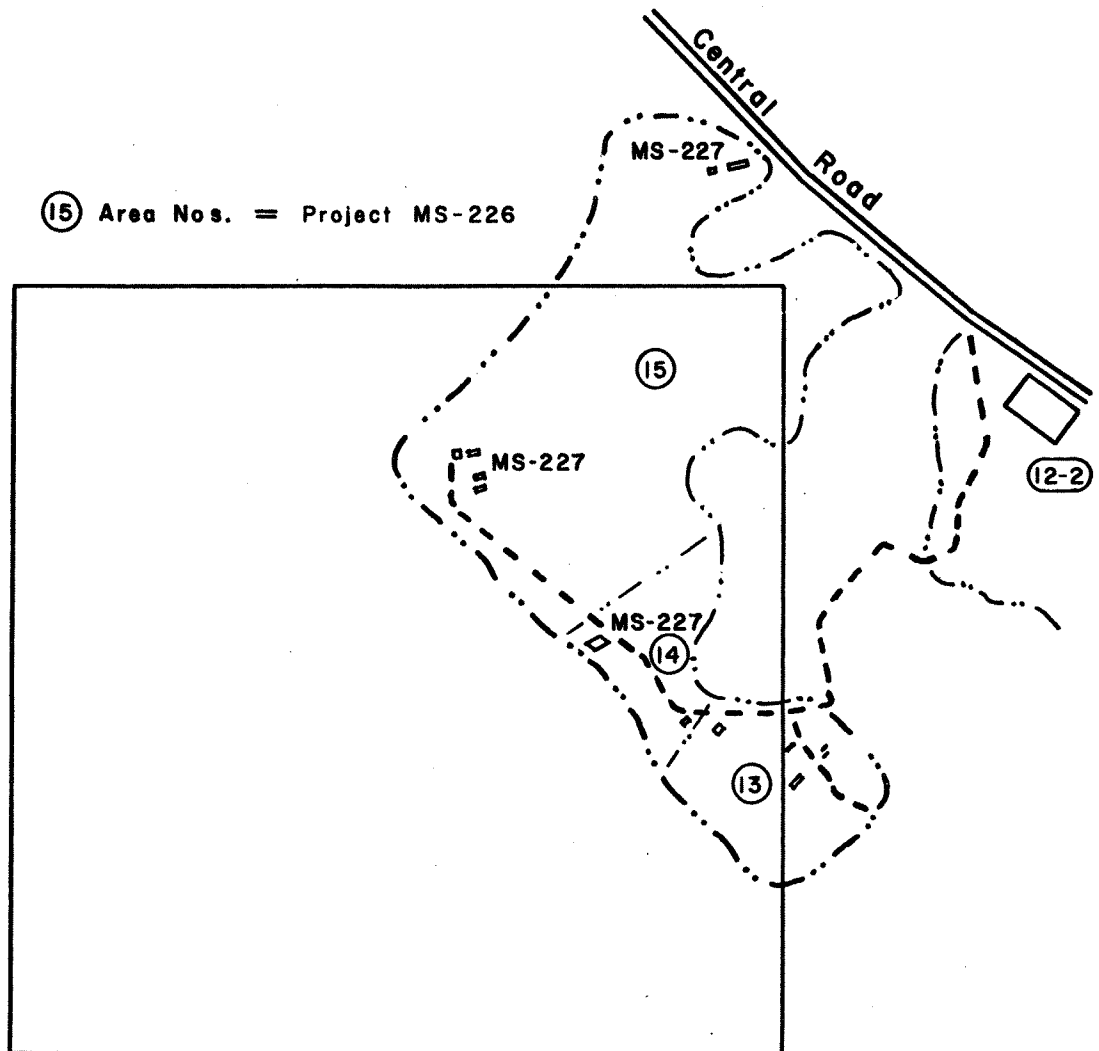

Scale: 1 inch = 20 chains

13 - 14 - Sec. 31, E.P.M.

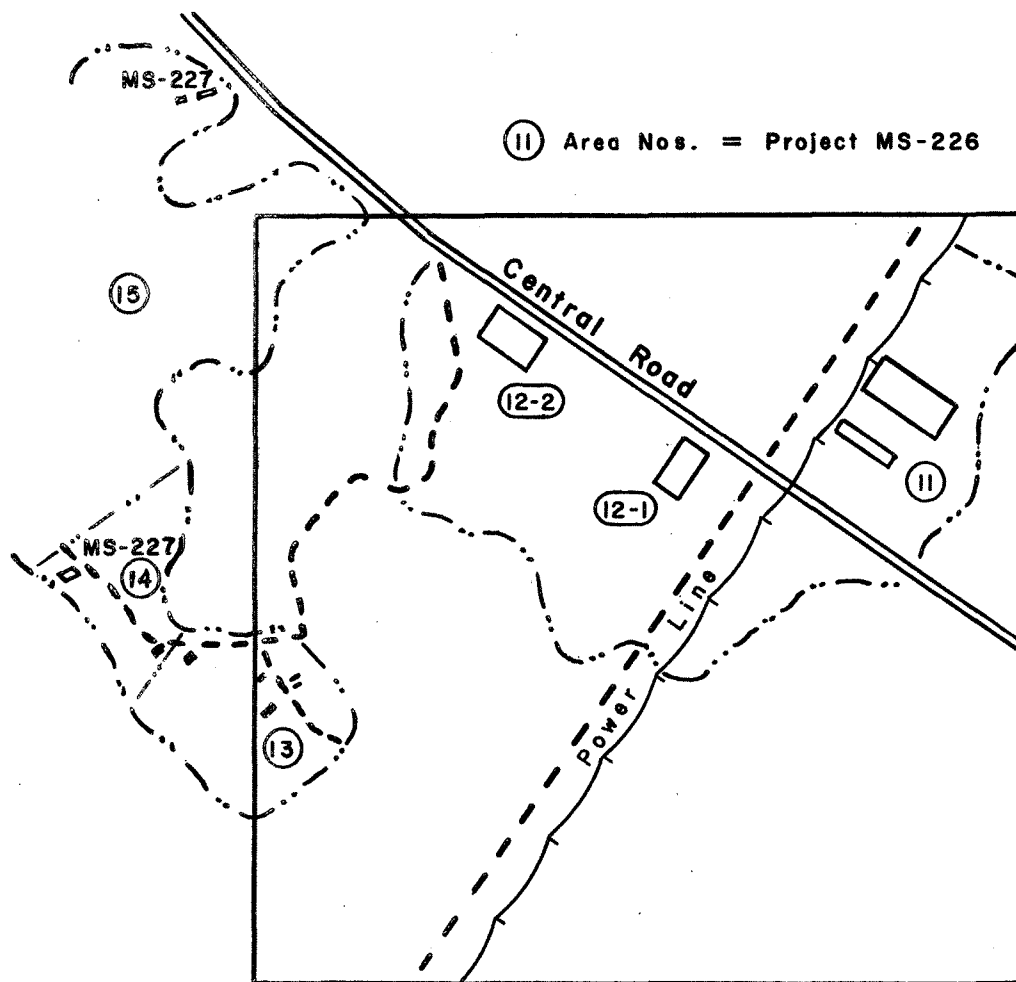

Scale: 1 inch = 20 chains

14 - 10 - Sec. 9, E.P.M.

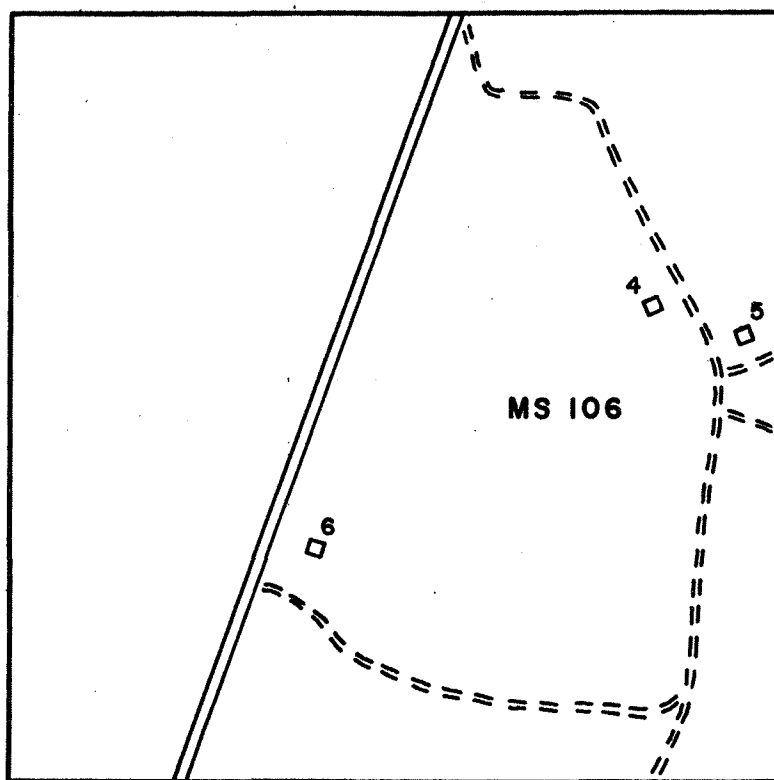

Scale: 1 inch = 20 chains

14 - 10 - Sec. 16, E.P.M.

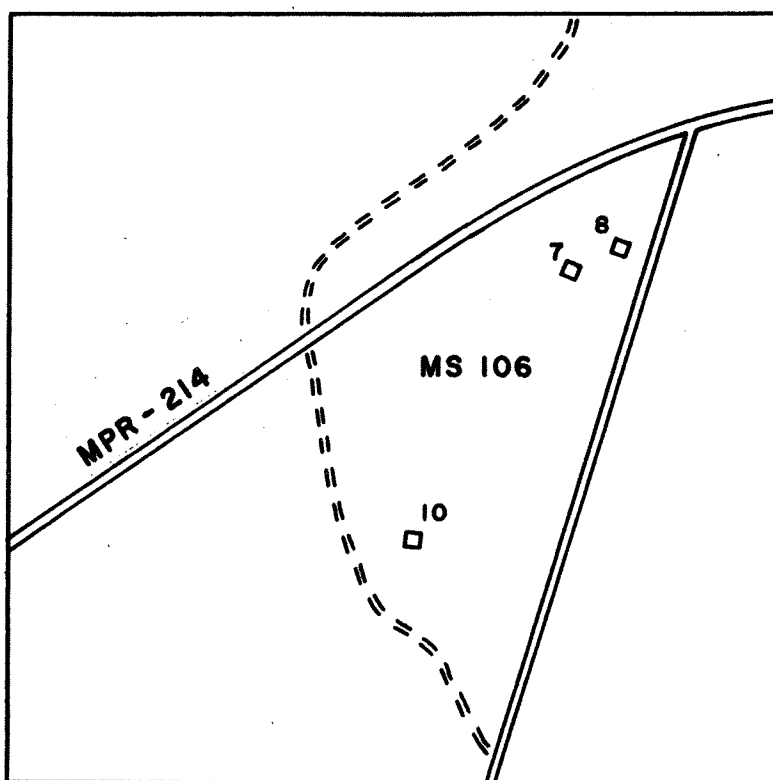

Scale: 1 inch = 20 chains

14 - 10 - Sec. 18, E.P.M.

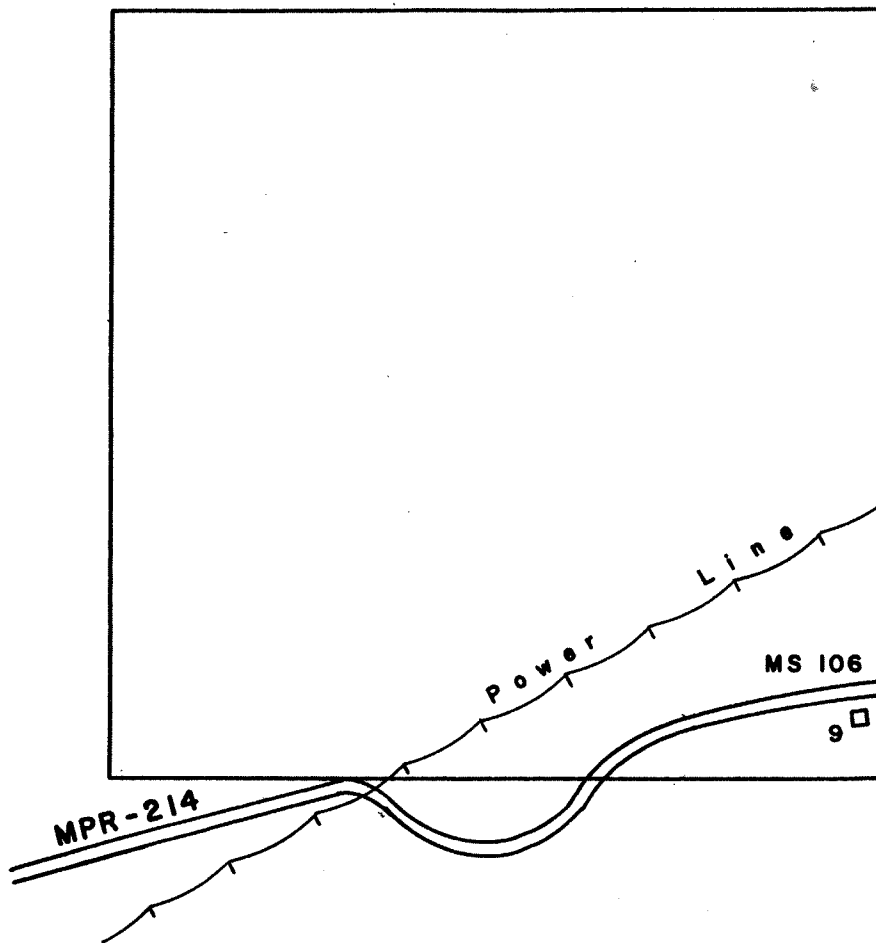

Scale: 1 inch = 20 chains

14 - 10 - Sec. 21, E.P.M.

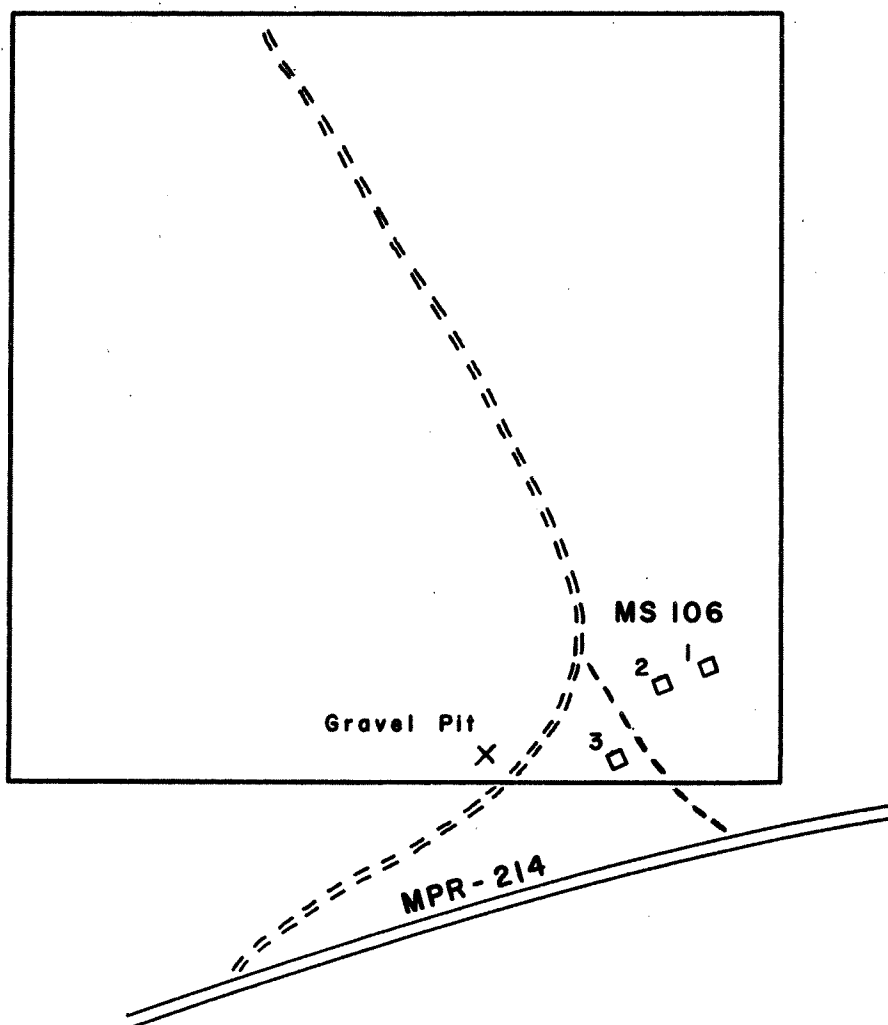

Scale: 1 inch = 20 chains

14 - 11 - Sec. 4, E.P.M.

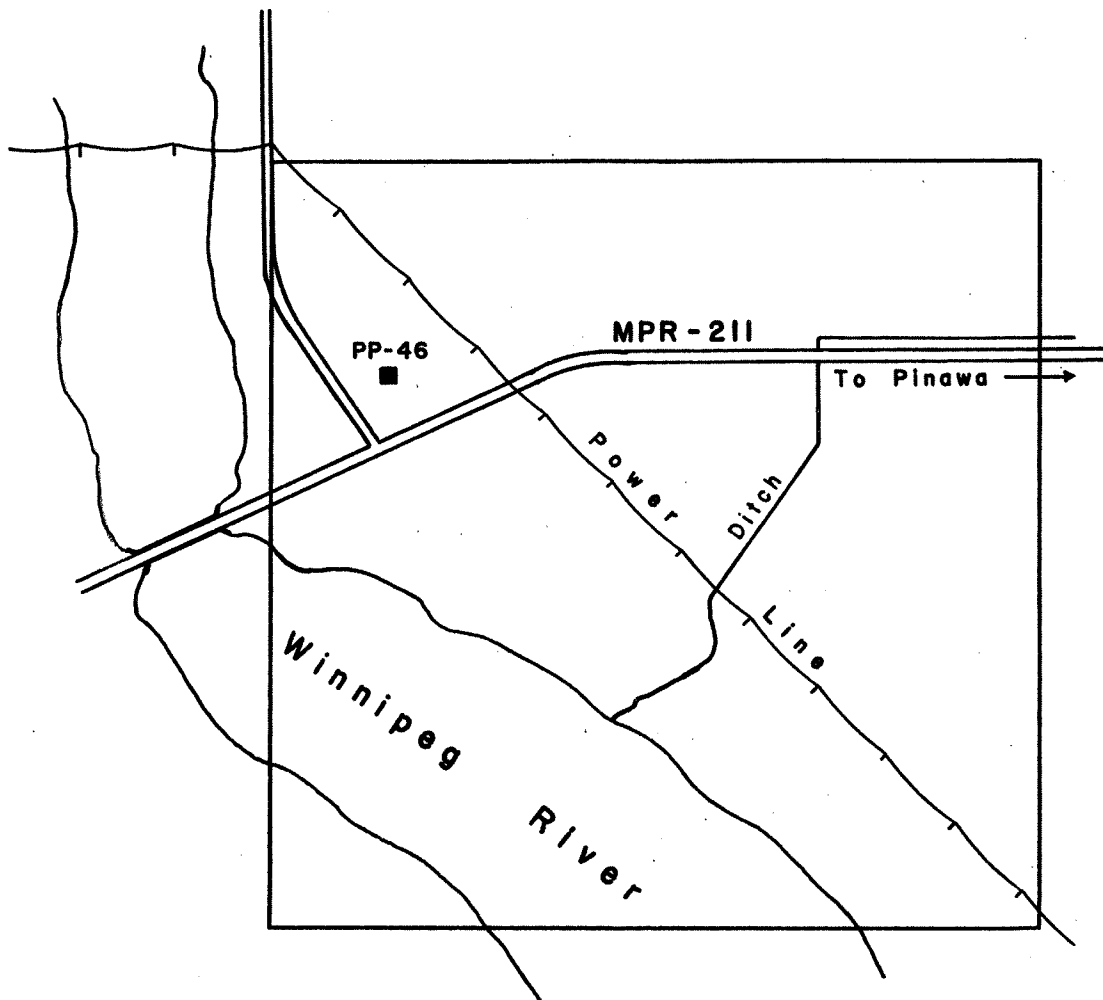

Scale: 1 inch = 20 chains

14-13-Sec.1, E.P.M.

⑮ Area No. = Project MS-226

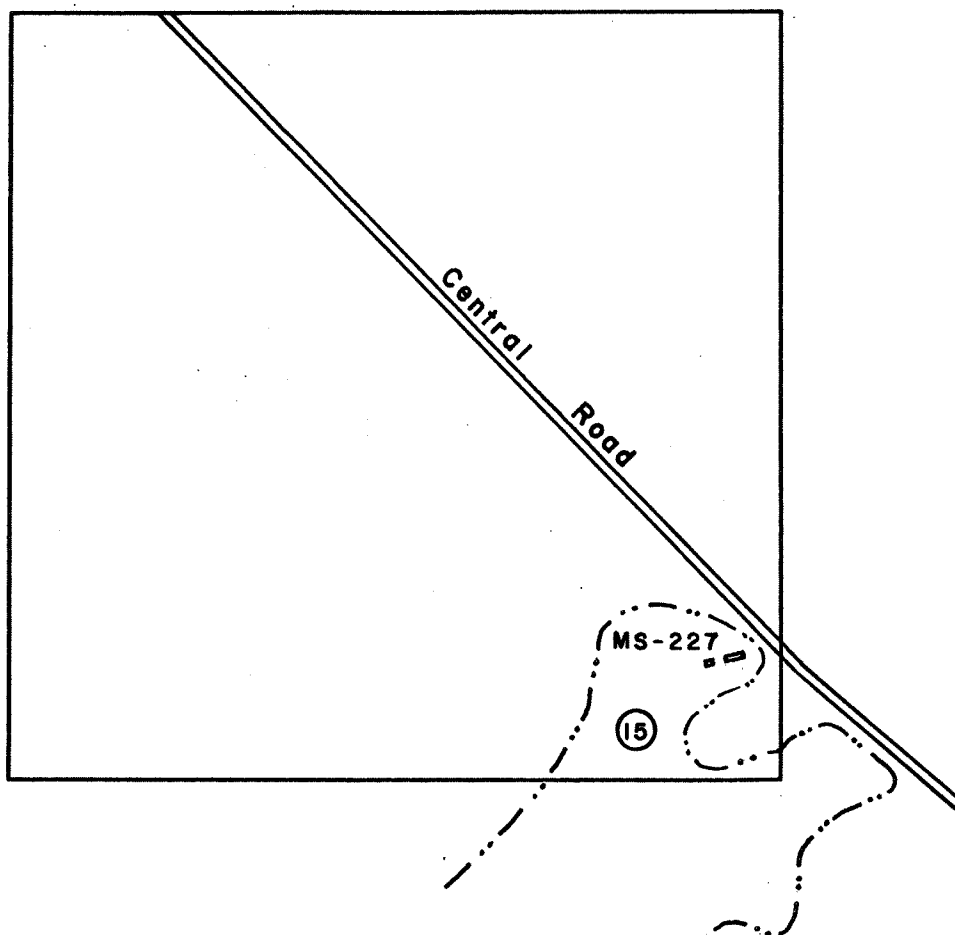

Scale: 1 inch = 20 chains

19 - 10 - Sec.10, E.P.M.

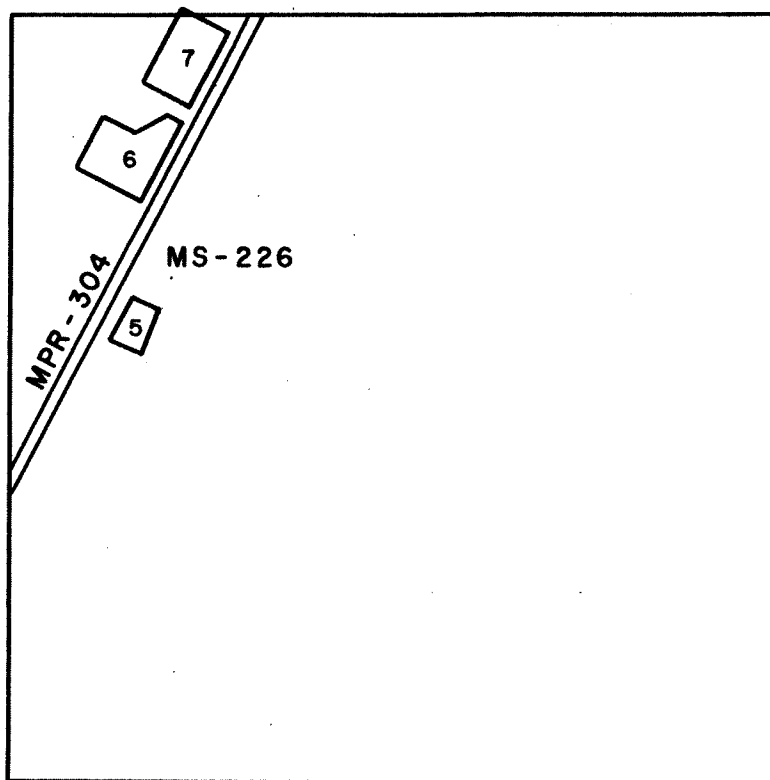

Scale: 1 inch = 20 chains

19-10 - Sec. 15, E.P.M.

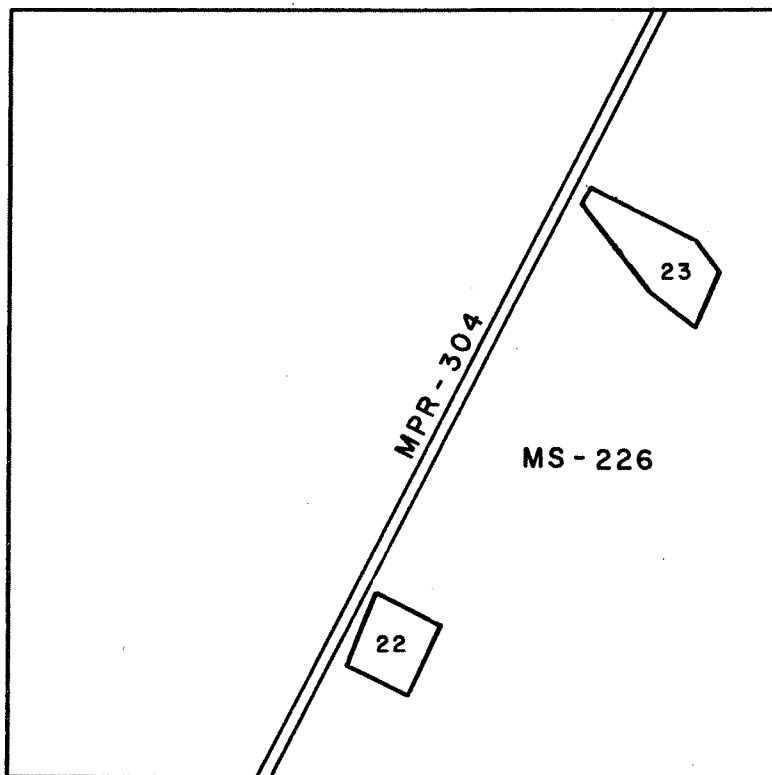

Scale: 1 inch = 20 chains

20 - 10 - Sec.12, E.P.M.

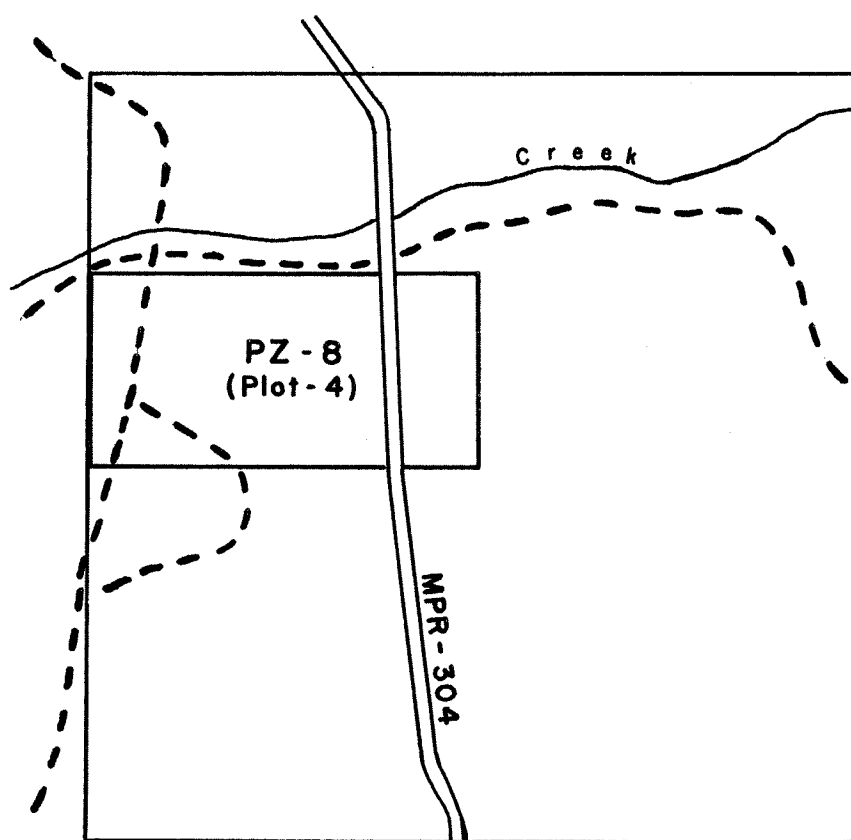

Scale: 1 inch = 20 chains

20 - 10 - Sec. 33, E.P.M.

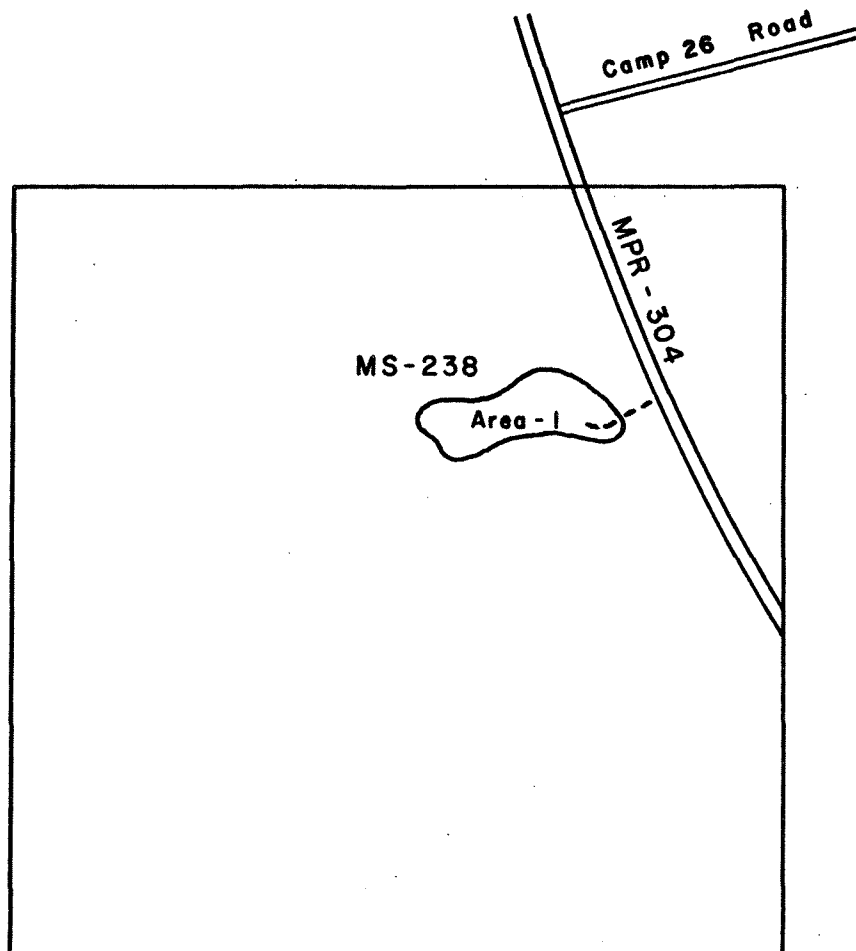

Scale: 1 inch = 20 chains

21 - 10 - Sec. 4, E.P.M.

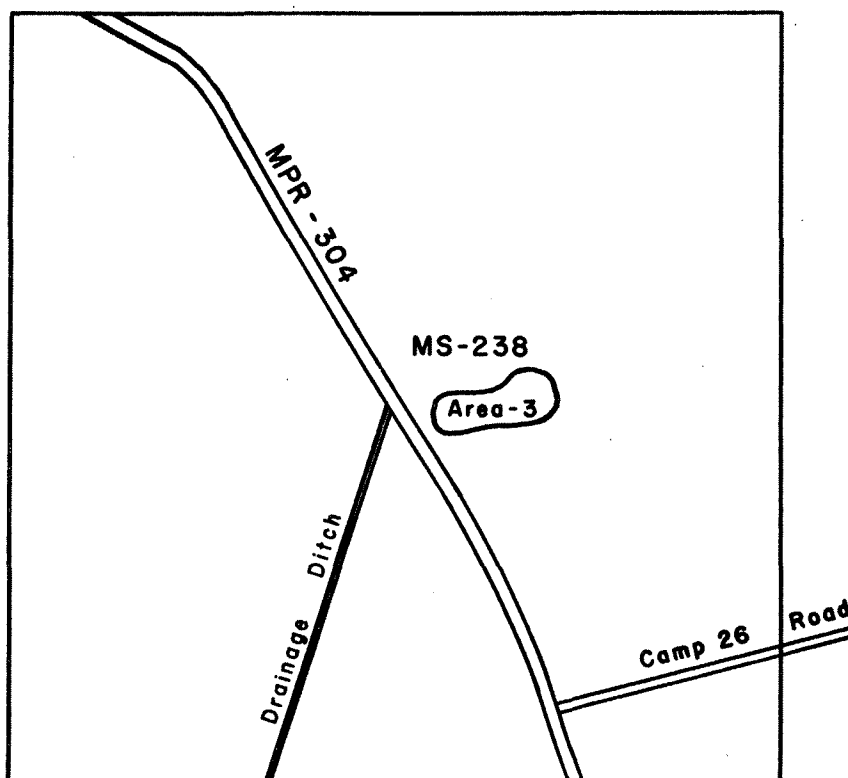

Scale: 1 inch = 20 chains

21 - 10 - Sec. 8, E.P.M.

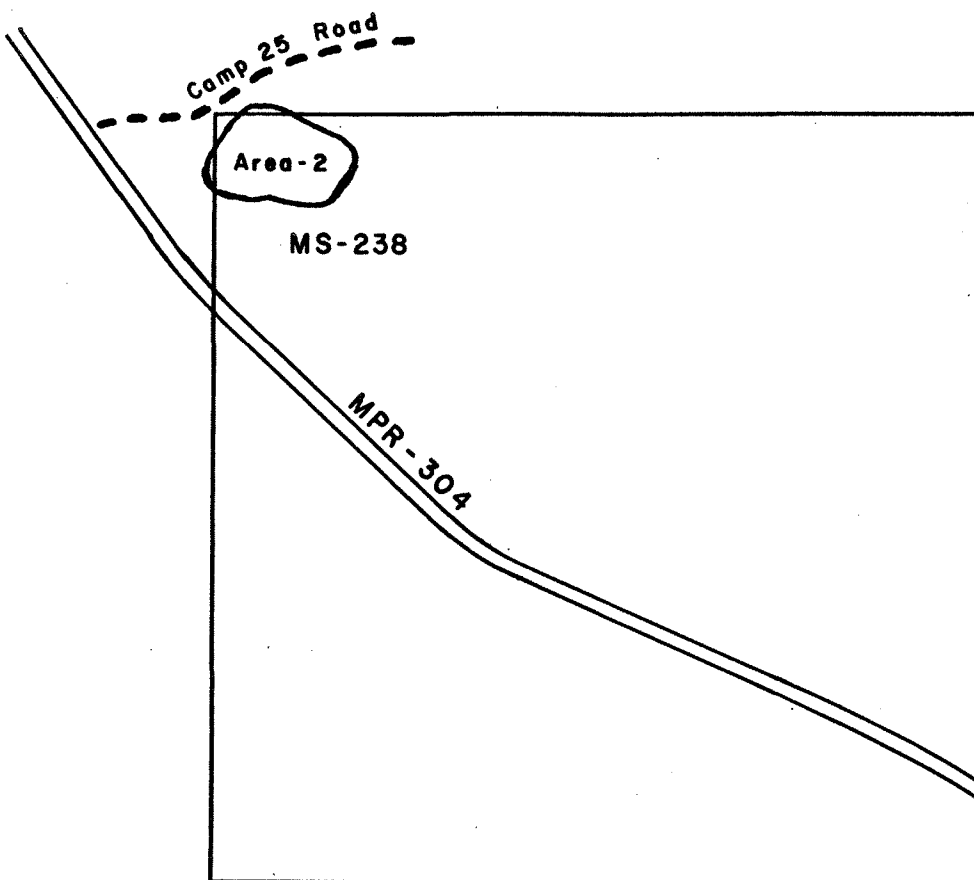

Scale: 1 inch = 20 chains

24 - 9 - Sec. 2, E.P.M.

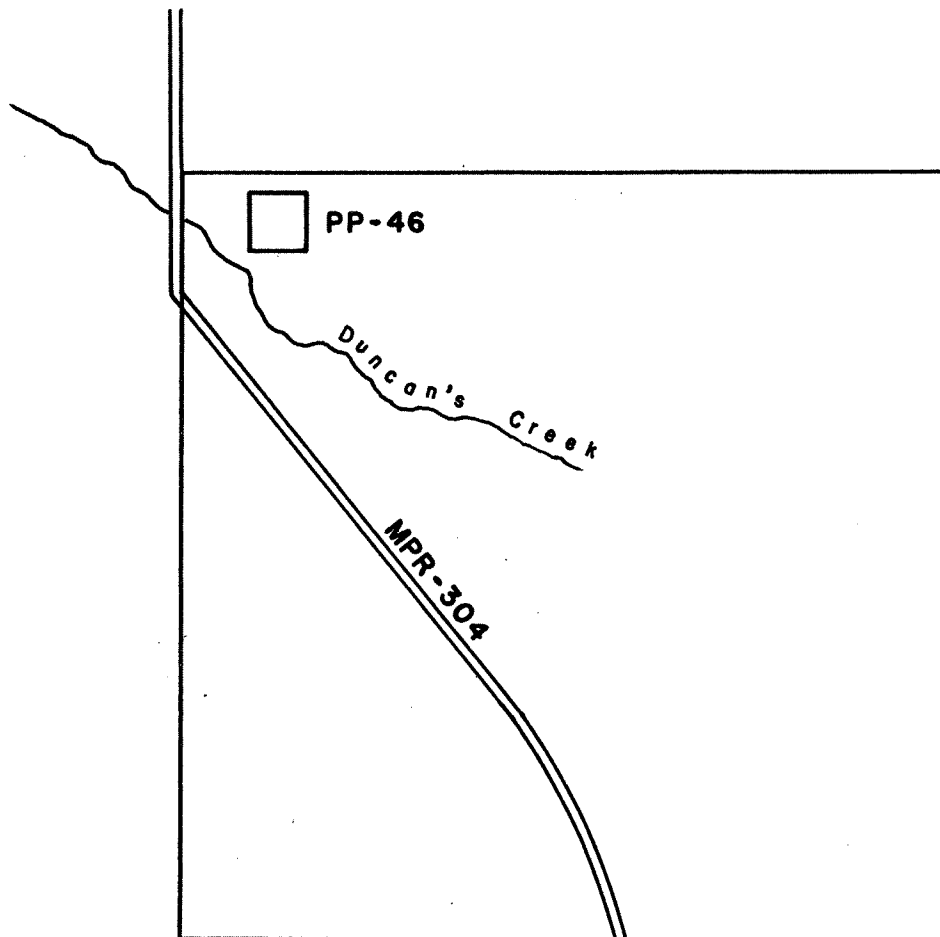

Scale: 1 inch = 20 chains

24 - 9 - Sec. 28, E.P.M.

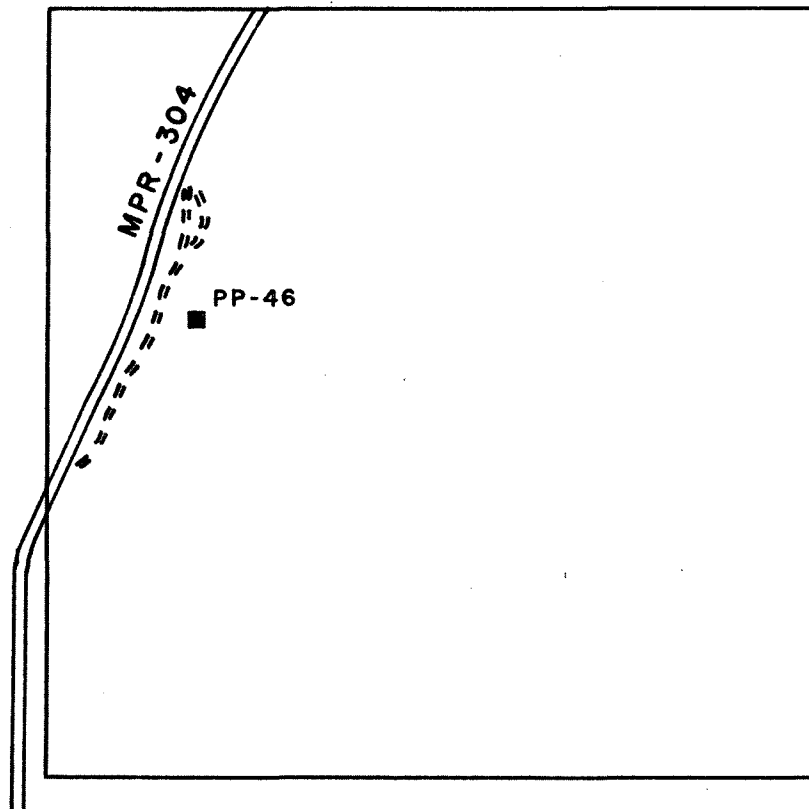

Scale: 1 inch = 20 chains

26 - 2 - Sec. 6, E.P.M.

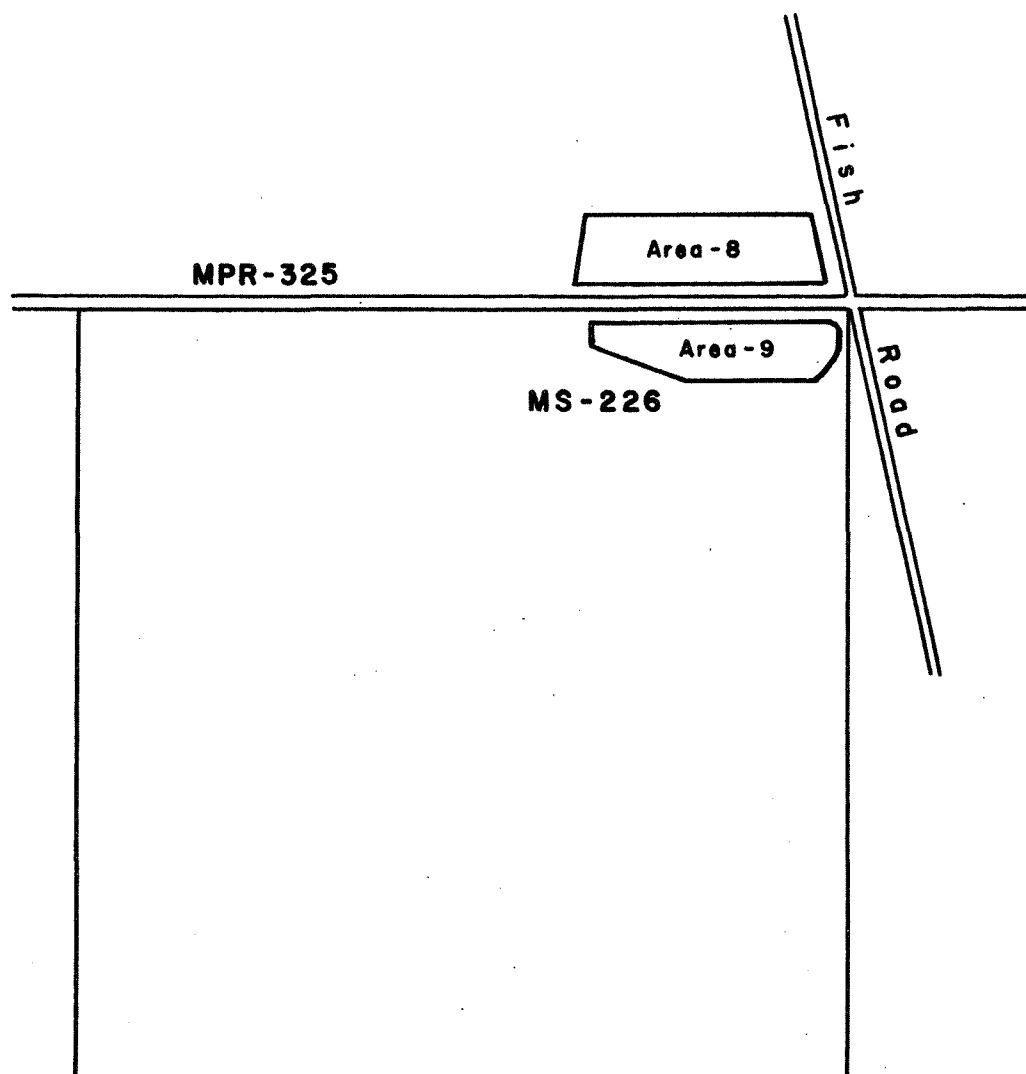

Scale: 1 inch = 20 chains

26 - 2 - Sec. 7, E.P.M.

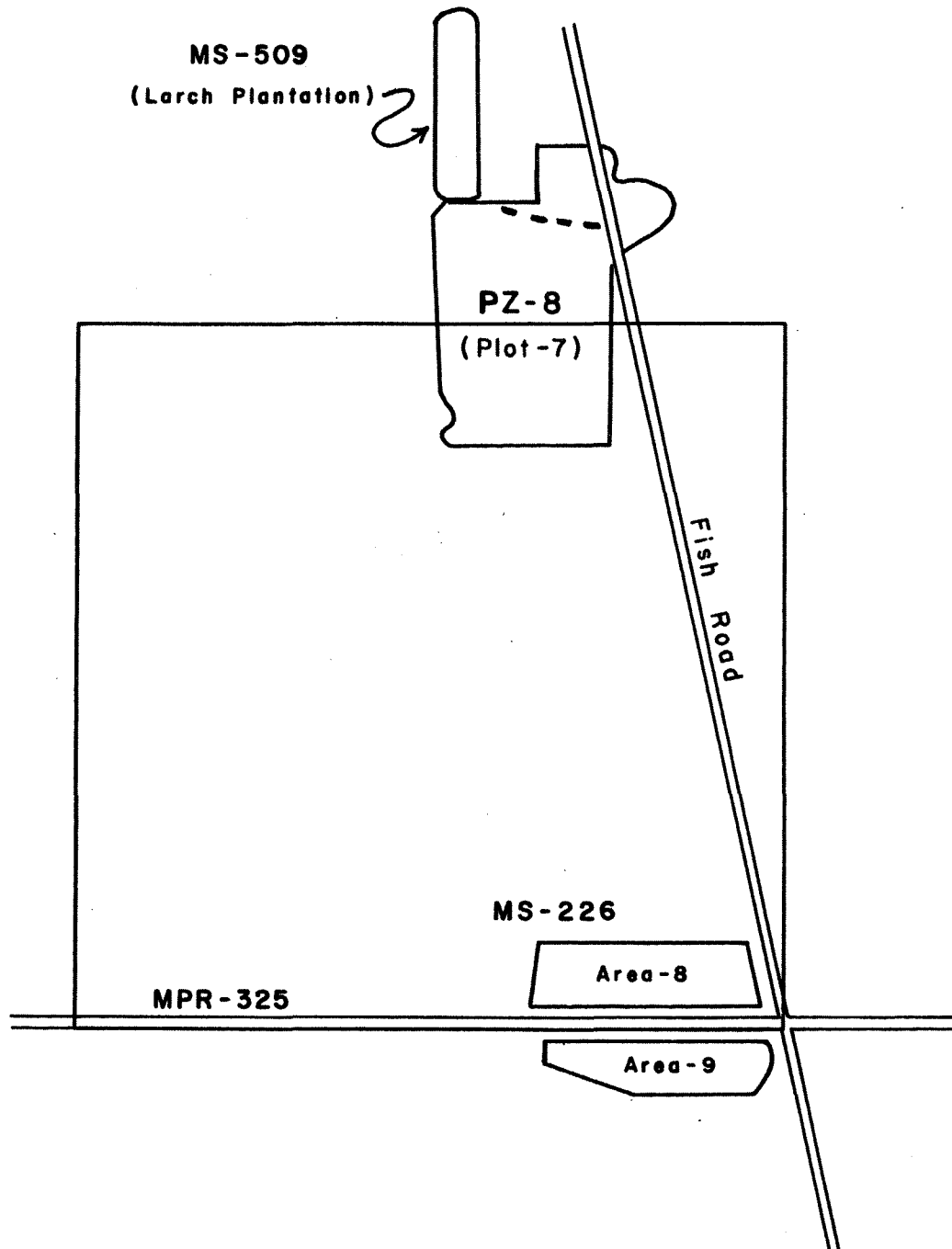

Scale: 1 inch = 20 chains

26 - 2 - Sec. 18, E.P.M.

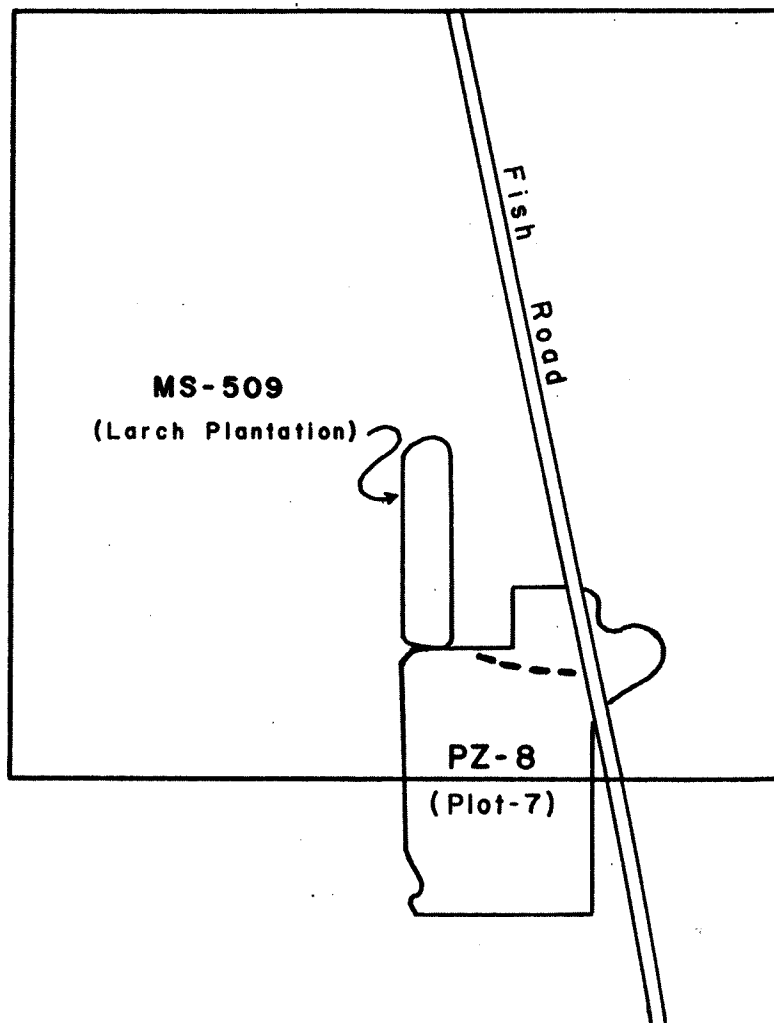

Scale: 1 inch = 20 chains

26 - 4 - Sec. 21, E.P.M.

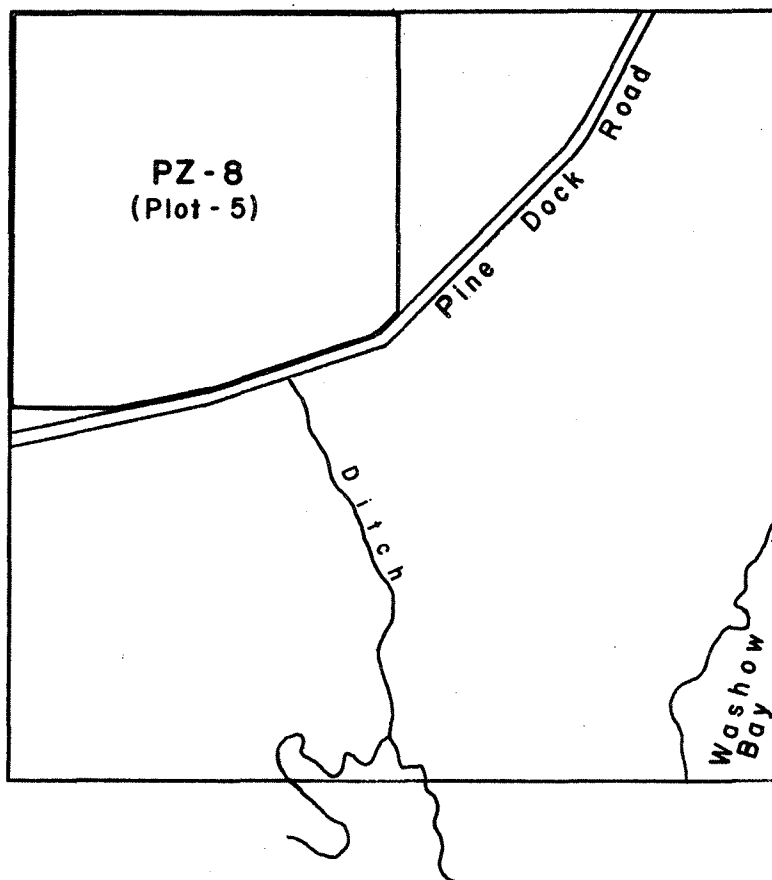

Scale: 1 inch = 20 chains

26 - 3 - Sec. 6, E.P.M.

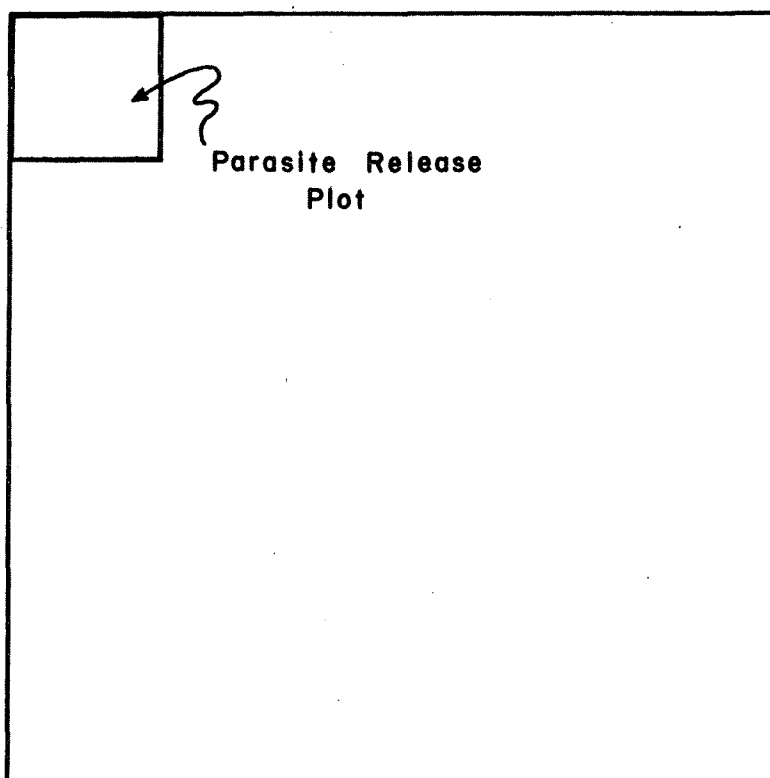

Scale: 1 inch = 20 chains

27 - 4 - Sec. 34, E.P.M.

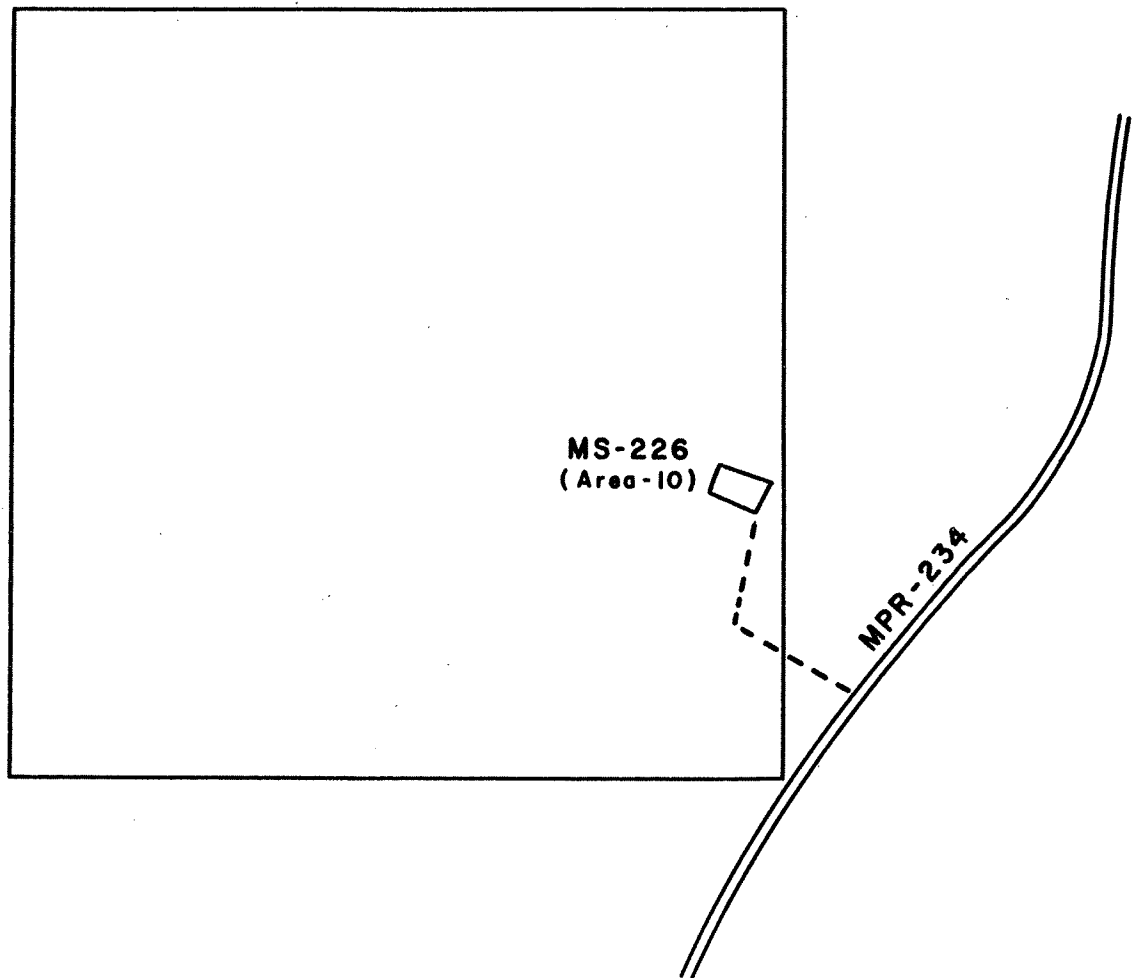

Scale: 1 inch = 20 chains

W.P.M.

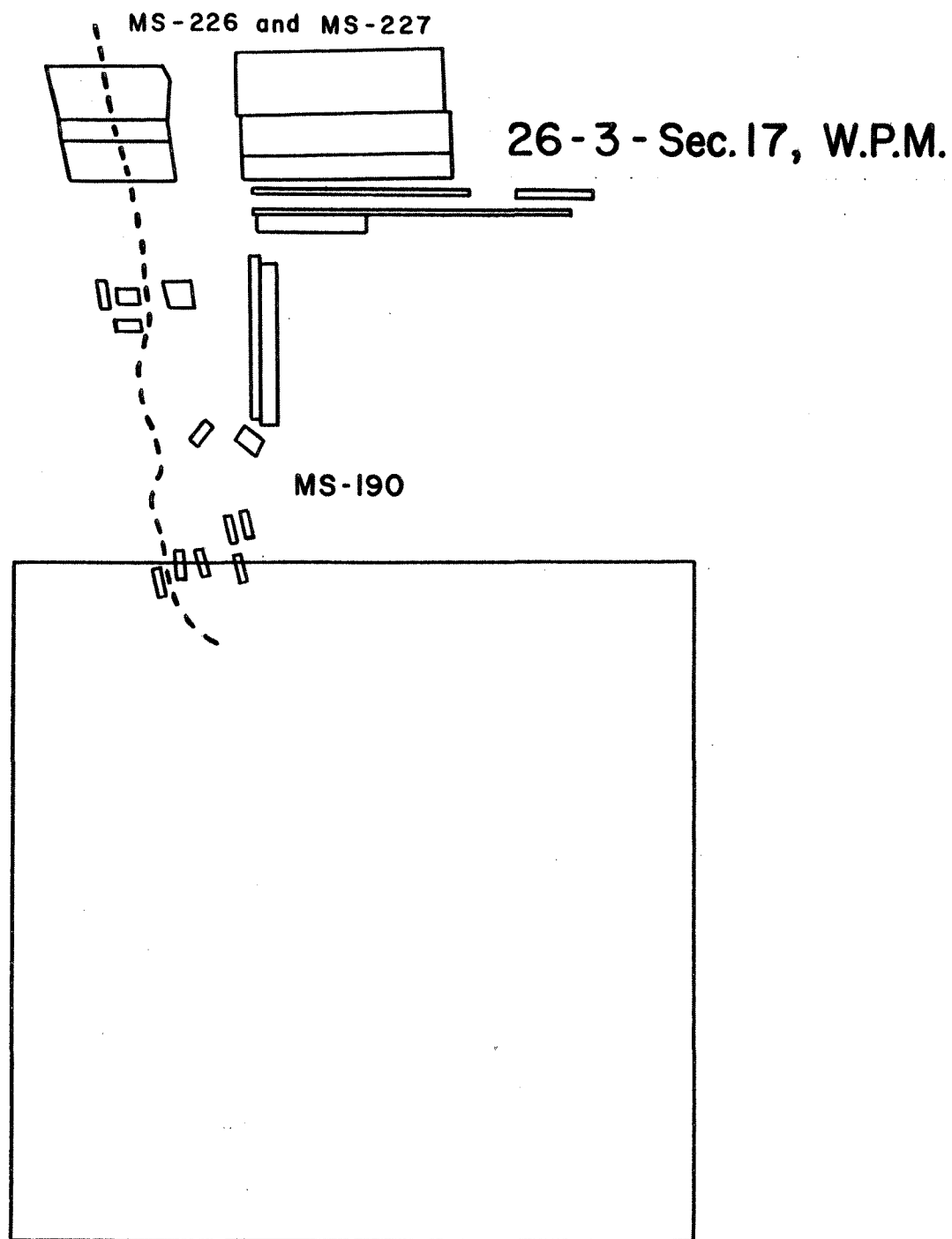

Scale: 1 inch = 20 chains

26 - 3 - Sec. 20, W.P.M.

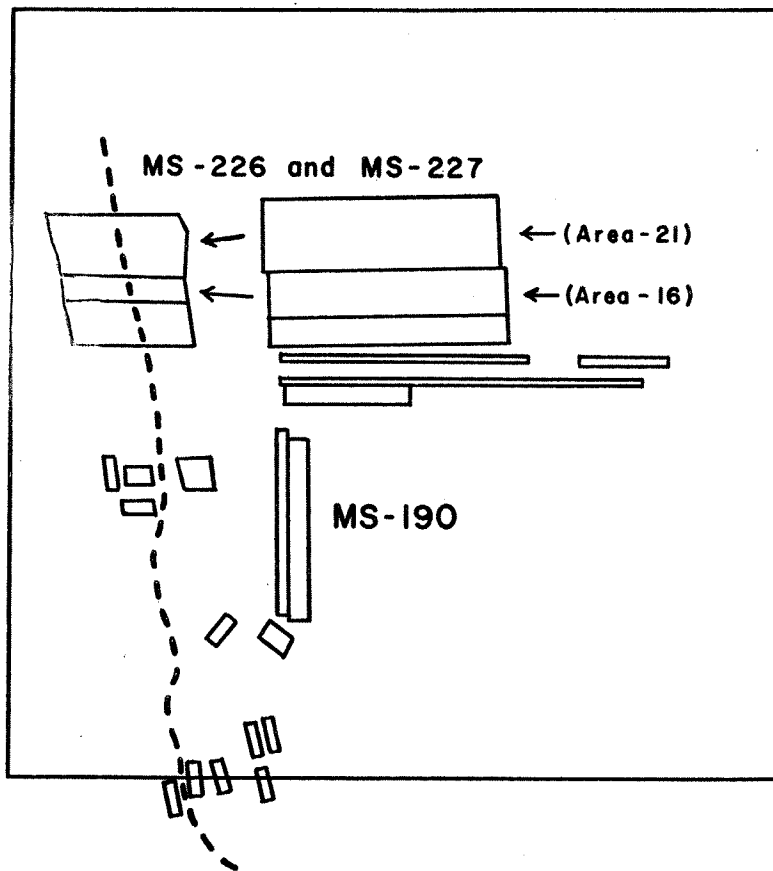

Scale: 1 inch = 20 chains

Projects

Project No.: MS-190

Title: Planting spruce and pine, Interlake Region, Manitoba

Investigator: R.M. Waldron and G.R. Hennessey

Section: Liaison and Services (Head, R.M. Waldron)

Location:

Township	Range	Section
26	3	17, 20 W.P.M.

Project No.: MS-226

Title: Converting aspen stands to white spruce by planting and seeding
on scalped strips, Manitoba

Investigator: R.E. Tucker

Section: Silviculture (Head, R.C. Dobbs)

Location:

Township	Range	Section		Area Nos.
10	16	14, 15 E.P.M.		17
13	13	36	E.P.M.	13, 14, 15
13	14	31	E.P.M.	11, 12-1, 12-2, 13
14	13	1	E.P.M.	15
19	10	10	E.P.M.	5, 6, 7
		15	E.P.M.	22, 23
26	2	6	E.P.M.	9
		7	E.P.M.	8
27	4	34	E.P.M.	10
26	3	20	W.P.M.	16, 21

Project No.: MS-227

Title: Early survival and growth of planted and seeded white spruce
as affected by seedbed types occurring on scalped strips prepared
in aspen stands, Manitoba

Investigator: R.E. Tucker

Section: Silviculture (Head, R.C. Dobbs)

Location:

Township	Range	Section
13	13	36 E.P.M.
14	13	1 E.P.M.

Project No.: MS-509

Title: Selecting and testing breeding material from Skinner's Nursery at
Dropmore, Manitoba (165.2)

Investigator: K.J. Roller

Selection: Tree improvement (Head, J.I. Klein)

Location:

Township	Range	Section	Remarks
26	2	18 E.P.M.	Larch plantation

Project No.: PP-46

Title: Decay of aspen

Investigator: R. E. Wall

Section: Pathology (Head, R. D. Whitney)

Location:

Township	Range	Section
11	15	33 E.P.M.
14	11	4 E.P.M.
24	9	2 E.P.M.
		28 E.P.M.

Project No.: PZ-8

Title: Larch sawfly eco-systems measurement

Investigator: J.A. Drouin and W.J. Turnock

Section: Entomology (Head, W.J. Turnock)

Location:

Township	Range	Section	Plot Nos.
10	15	24 E.P.M.	2
12	15	17 E.P.M.	1
20	10	12 E.P.M.	8
26	2	7, 18 E.P.M.	7
26	4	21 E.P.M.	5

Project No.: Nil

Title: Bavarian Mesaleius Tenthredinis release plot

Investigator: J. A. Muldrew

Section: Entomology (Head, W.J. Turnock)

Location:

Township	Range	Section	Remarks
26	3	6 E.P.M.	Parasite release plot

Project No.: O.D.C. 235.1

Title: Under planting trembling aspen with white spruce 1965 Falcon
Lake, Manitoba

Investigator: R.M. Waldron and G.R. Hennessey

Section: Liaison and Services (Head, R.M. Waldron)

Location :

Township	Range	Section	Plot Nos.
8	16	21 E.P.M.	1-9

Project No.: MS 106

Title: The growth habit of trembling aspen, Manitoba (doctoral thesis)

Investigator: G.A. Steneker

Section: Silviculture (Head, R.C. Dobbs)

Location:

Township	Range	Section	Plot Nos.
14	10	9 E.P.M.	4-6..
		16 E.P.M.	7, 8, 10
		18 E.P.M.	9
		21 E.P.M.	1-3